

HEATING PRODUCTS [230V 750W (IIE Heater)]

EWEB 6102

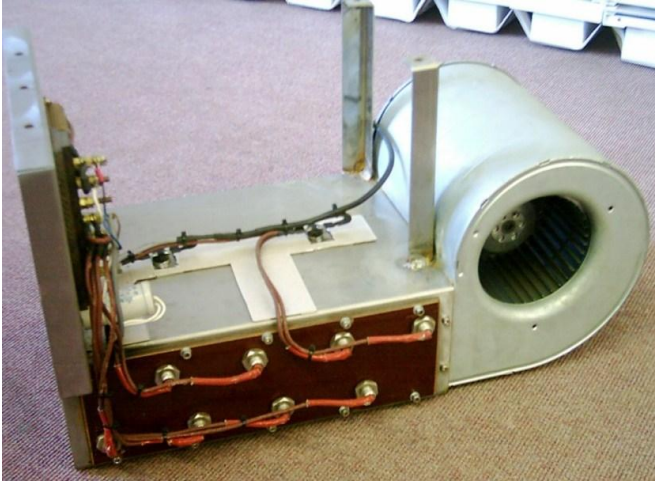

DESCRIPTION:

The IIE Heater is a 230Vac 750W heater. It has 4 switching positions; off, high fan, low heat, high heat. The heat is generated by 4 x 750W elements. All these elements have thermal cut-out switches on them for safety precautions.

FEATURES:

- Centrifugal Fan
- Thermal cut-out switches
- 4 switching positions
- 4 x 750W Elements

OUTLINE DIMENSIONS (in millimetres):

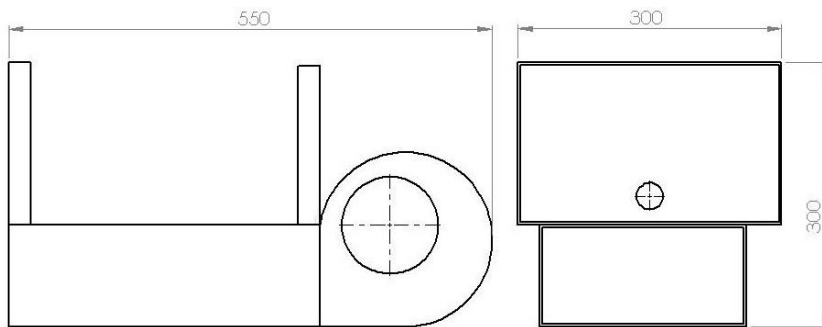

SPECIFICATION SHEET:

SPECIFICATIONS	DATA
HEATER SWITCHING POSITIONS	1. OFF 2. HIGH FAN 3. LOW HEAT 4. HIGH HEAT
INPUT VOLTAGE	220Vac
ELEMENT INPUT VOLTAGE	220Vac
NUMBER. OF ELEMENTS	4
ELEMENT WATTAGE	750W / ELEMENT
ELEMENT CURRENT (BOTTOM)	± 6A
ELEMENT CURRENT (TOP)	± 6A
FAN MOTOR	220Vac CENTRIFUGAL FAN
FAN CURRENT	± 750mA
OVER-TEMP. PROTECTION	80°C THERMAL CUT OUT SWITCHES
OVERALL SIZE (L x W x H) mm	550 x 300 x 300 mm
MASS	12KG