

HEATING PRODUCTS [750V 750W Heater-3rd Class]

EWEB 6201

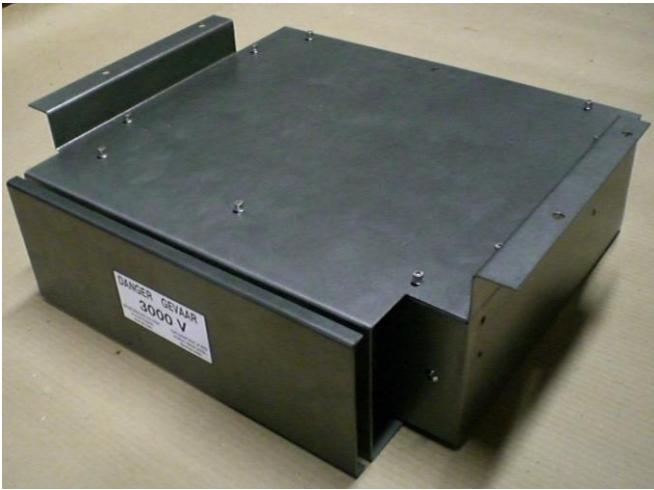

DESCRIPTION:

The heater system is constructed of a robust sheet metal enclosure specially made to accommodate the heating element, fan, temperature sensor, and the full-bridge driver. The latter provides a stable 28Vac output to the fan with a supply varying between 60Vdc and 160Vdc. A double lid makes the heater front cover safe for all commuters

FEATURES:

- Centrifugal Fan
- Thermal cut-out switch
- 1 x 750W Element

OUTLINE DIMENSIONS (in millimetres):

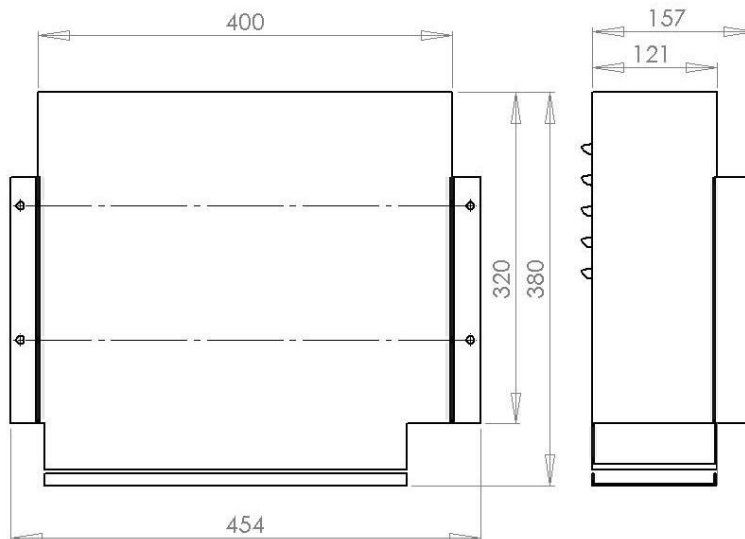

SPECIFICATION SHEET:

SPECIFICATIONS	DATA
750Vdc 750W UNDERSEAT HEATER - 3rd CLASS	
INPUT VOLTAGES	750Vdc
ELEMENT INPUT VOLTAGE	750Vdc
NUMBER. OF ELEMENTS	1
ELEMENT WATTAGE	750W
ELEMENT CURRENT	± 1.5A
FAN INPUT VOLTAGE	25Vdc (DC - DC CONVERTER)
OVER-TEMP. PROTECTION	100°C THERMAL CUT OUT SWITCHES
OVERALL SIZE (L x W x H) mm	380 x 454 x 157 mm
MASS	11KG